

The world's favorite lock



5000 Series Mortise Locks



contents

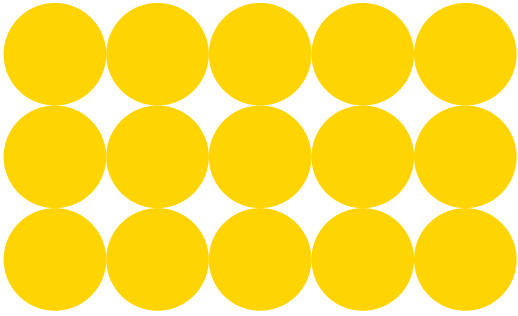

Features and Specifications	3
Product Limiting Dimensions	4
Lock Functionality	5-6
Product Classifications	7
How to Order	7

5000 Series Mortise Locks

A range of Yale Mortise Locks consists of various functions to meet most security and locking requirements.

Features and Specifications

Standards

- Complies to EN12209:2003 Grade 3
- Fire Safety Standard EN1634-1

Strength & Durability

- Suit for 30 minutes and 60 minutes Fire Doors

Backset

- 60mm

Centers

- 72mm as standard
78mm for Privacy Lock Case

Spindle Size

- 8mm X 8mm

Door Thickness

- Standard offer Door Thickness range 35mm - 50mm.
Other Door Thickness range upon request

Handing

- Easily Reversible design without opening lock case.
Nightlatch & Panic Proof Sashlock with non-handed design.

Materials

- Zinc Plated Steel Lock Case; Stainless Steel Latchbolt, Deadbolt, Forend & Strike (Square or Radius Available)

Fixing/Pitching

- Full concealed mortise lock.



Application

Yale 5000 Series Mortise Lock is suitable for Fire Doors in Commercial / Public Buildings.

This innovative mortise lock range, features a non handed design which is easy to install and suitable for new and most retrofit applications.

Product Range

Various locking function selection easily reversible and non-handed designs makes this mortise lock versatile for most doors. A wide selection of door furniture options are available to suit Yale Mortise Lock series.

Refer to Door Furniture Section of your Yale Catalogue.

Deadbolt

20mm throw on a single turn of key or thumbturn.

Standard Finishes

Forend and Strike in Satin Stainless Steel (SS) or Polished Stainless Steel (PS)

Locking Functions

- Passage Latch
- Privacy Lock Case
- Entrance (Sashlock) Lock Case
- Deadbolt Lock Case
- Nightlatch Lock Case
- Panic Proof Sashlock

Mortise Locks

Product Limiting Dimensions

Lock Case

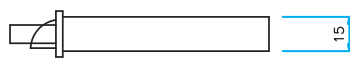
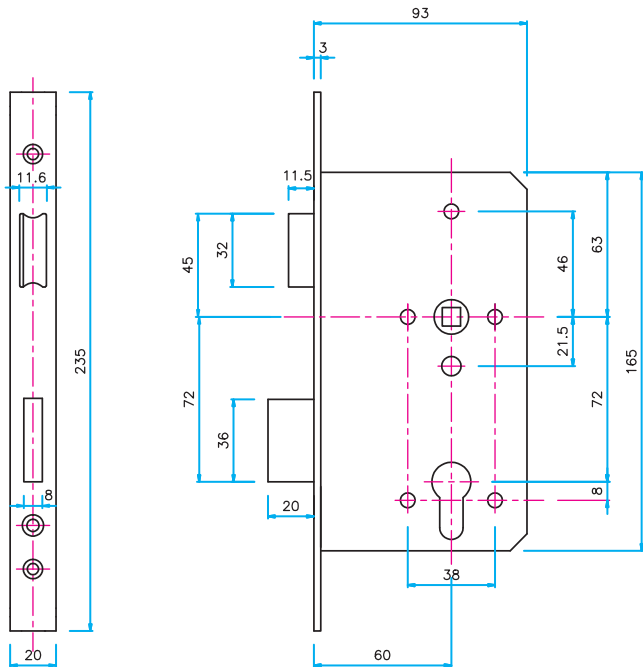

Standard

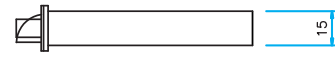
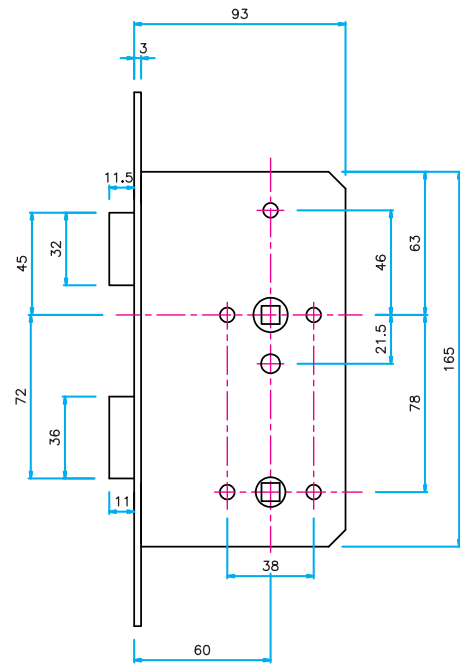

5008 Privacy

Lock Case

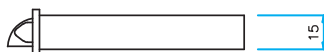
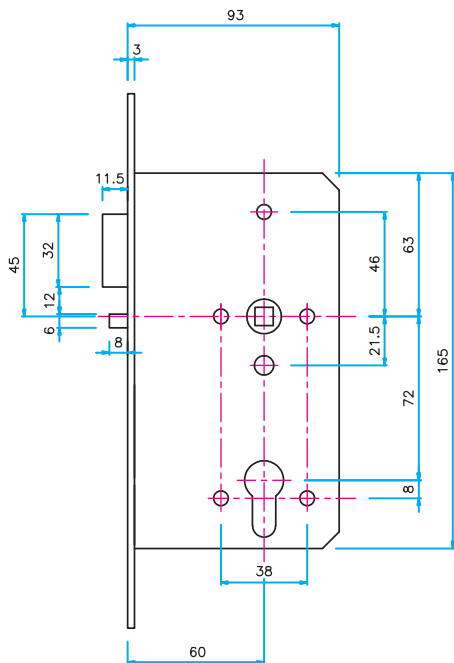

5006 Nightlatch

Strikes for different functions

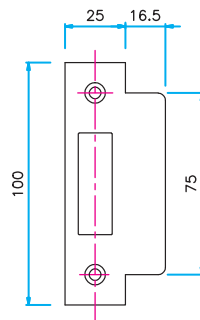

5001 Passage

5006 Nightlatch

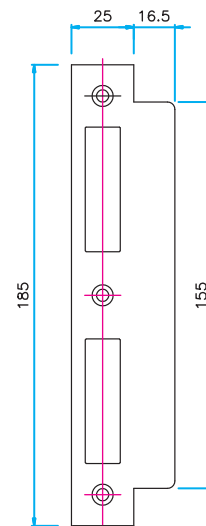

5008 Privacy

5003 Entrance Sashlock

500AE Panic Proof Sashlock

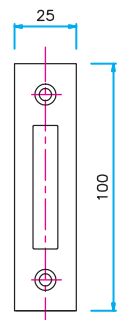

5004 Deadbolt

All dimensions are in mm

Lock Functionality

Passage

Lock case:

5001

Finish:

SS - Satin Stainless Steel

PS - Polished Stainless Steel

Description:

Yale Euro Mortise Lock

Backset: 60mm

Door thickness: 35mm to 50mm

Outside

- Latchbolt operated by lever all the times

Inside

- Latchbolt operated by lever all the times

Product Classification

3X810F-B020

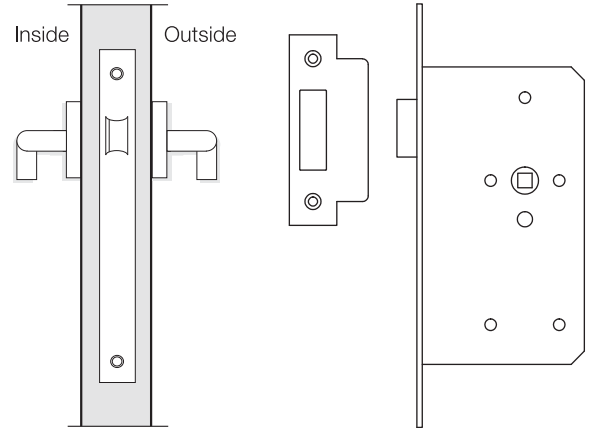

Lock case	Face plate		Finish	
5001	S	Standard, Square Ends	SS	Satin Stainless Steel
	R	Optional, Round Ends	PS	Polished Stainless Steel

Privacy

Lock case:

5008

Finish:

SS - Satin Stainless Steel

PS - Polished Stainless Steel

Description:

Yale Euro Mortise Lock

Backset: 60mm

C to C: 78mm

Door thickness: 35mm to 50mm

Outside

- Latchbolt operated by lever
- Deadbolt operated by emergency release with coin

Inside

- Deadbolt operated by thumbturn

Product Classification

3X810F-BG20

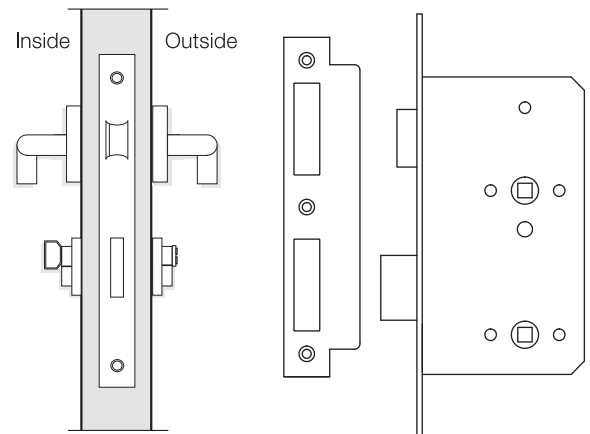

Lock case	Face plate		Finish	
5008	S	Standard, Square Ends	SS	Satin Stainless Steel
	R	Optional, Round Ends	PS	Polished Stainless Steel

Entrance (Sashlock)

Lock case:

5003

Finish:

SS - Satin Stainless Steel

PS - Polished Stainless Steel

Description:

Yale Euro Mortise Lock

Backset: 60mm

C to C: 72mm

Door thickness: 35mm to 50mm

Outside

- Latchbolt operated by lever or key cylinder
- Deadbolt operated by key cylinder

Inside

- Latchbolt and deadbolt operated by thumbturn
- Latchbolt operated by lever

Product Classification

3X810F3BA20

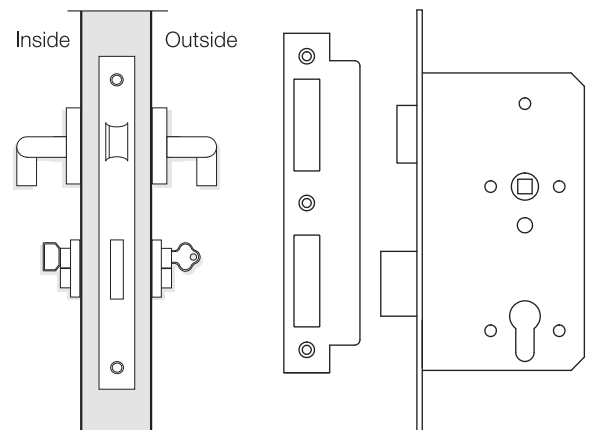

Lock case	Face plate		Finish	
5003	S	Standard, Square Ends	SS	Satin Stainless Steel
	R	Optional, Round Ends	PS	Polished Stainless Steel

Mortise Locks

Lock Functionality

Deadbolt

Lock case:
5004

Finish:
SS - Satin Stainless Steel
PS - Polished Stainless Steel

Description:
Yale Euro Mortise Lock
Backset: 60mm
C to C: 72mm
Door thickness: 35mm to 50mm

- Outside**
- Deadbolt operated by key cylinder
- Inside**
- Deadbolt operated by key cylinder or thumbturn

Product Classification
3X810F3BA00

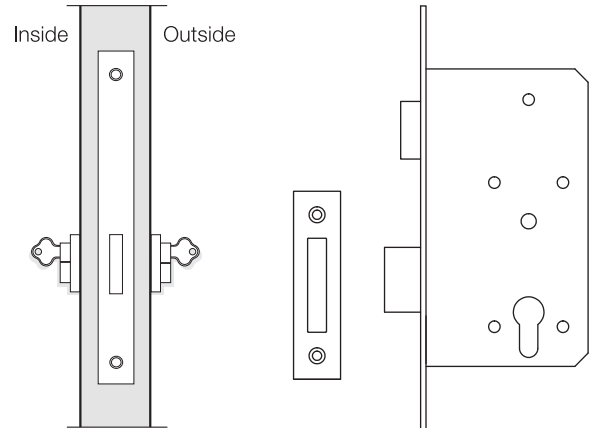

Lock case	Face plate		Finish	
5004	S	Standard, Square Ends	SS	Satin Stainless Steel
	R	Optional, Round Ends	PS	Polished Stainless Steel

Nightlatch

Lock case:
5006

Finish:
SS - Satin Stainless Steel
PS - Polished Stainless Steel

Description:
Yale Euro Mortise Lock
Backset: 60mm
C to C: 72mm
Door thickness: 35mm to 50mm

- Outside**
- Latchbolt operated by key cylinder
 - Rigid handle outside
- Inside**
- Unlocking all the times
 - Internal lever always free

Product Classification
3X810F1BB20

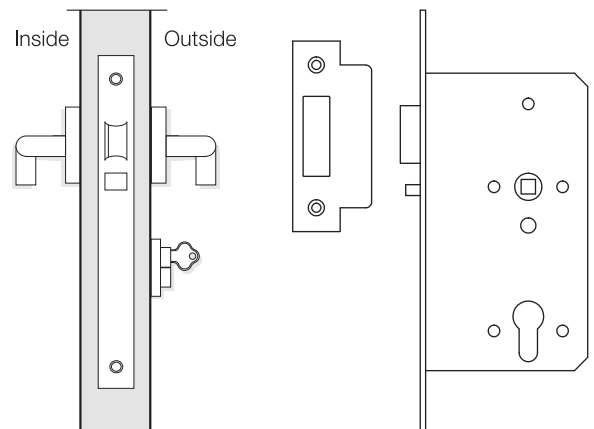

Lock case	Face plate		Finish	
5006	S	Standard, Square Ends	SS	Satin Stainless Steel
	R	Optional, Round Ends	PS	Polished Stainless Steel

Panic Proof Sashlock

Lock case:
500AE

Finish:
SS - Satin Stainless Steel
PS - Polished Stainless Steel

Description:
Yale Euro Mortise Lock
Backset: 60mm
C to C: 72mm
Door thickness: 35mm to 50mm

- Outside**
- Latchbolt operated by lever or key cylinder
 - Deadbolt operated by key cylinder
- Inside**
- Latchbolt and deadbolt operated by lever all the times
 - Latchbolt and deadbolt operated by thumbturn

Product Classification
3X810F3BA20

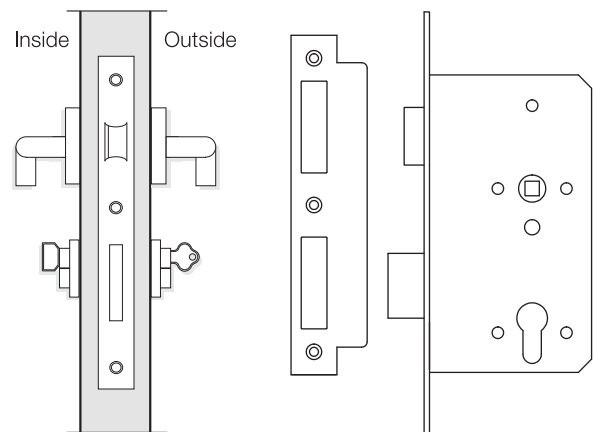

Lock case	Face plate		Finish	
500AE	S	Standard, Square Ends	SS	Satin Stainless Steel
	R	Optional, Round Ends	PS	Polished Stainless Steel